



4 Bedrooms + 3 Baths
Approx. 3050 heated s.f.
Finished Bonus Room
\$439,900 MLS #968908
Lot 187 / 359 Bellemont



The Rosemore Place

- ❖ Main floor master suite with tray ceiling, separate and spacious his and her walk-in closets, tiled luxury bathroom features garden tub and shower with seat.
- ❖ Home office or in-law/nanny bedroom suite on main floor
- ❖ Gourmet kitchen with work island, serving bar, and roomy pantry
- ❖ Two fireplaces create warm gathering places
- ❖ Spacious laundry room accesses garage
- ❖ Generous secondary bedrooms upstairs with large walk-in closets

All prices are subject to lot premiums for location, view, trees and topography.
Prices and plans subject to change without notice. Information deemed reliable but not guaranteed.

VOLLER
REALTY & CONSTRUCTION, LTD.
HOME & LAND SALES

On-Site Sales Office

919-545-2858

www.vollerrealty.com





Chatham Forest™
 HISTORIC PITTSBORO

The Rosemore Place

- Dining 12' x 13'3"
- Family Room . . . 16' x 19'
- Kitchen 18' x 11'
- Keeping Room 15'5" x 13'9"
- Bedroom/Study 11'6" x 11'7"
- Master BR 14' x 20'
- Bedroom/Study 11'9" x 12'
- Bedroom 2 . . . 12' x 13'3"
- Bedroom 3 . . . 12' x 13'7"
- Bonus Room . 12'5" x 19'9"
- 2-car Garage 20'5" x 21'9"

Downstairs

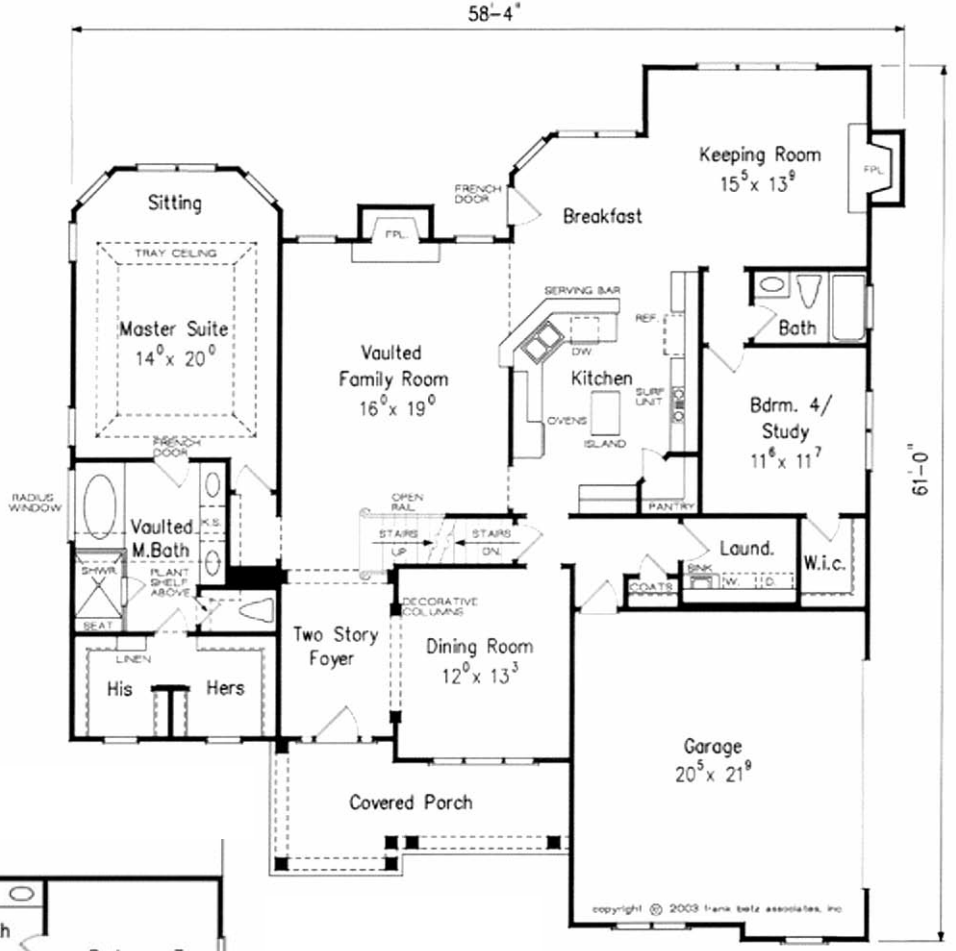

Upstairs

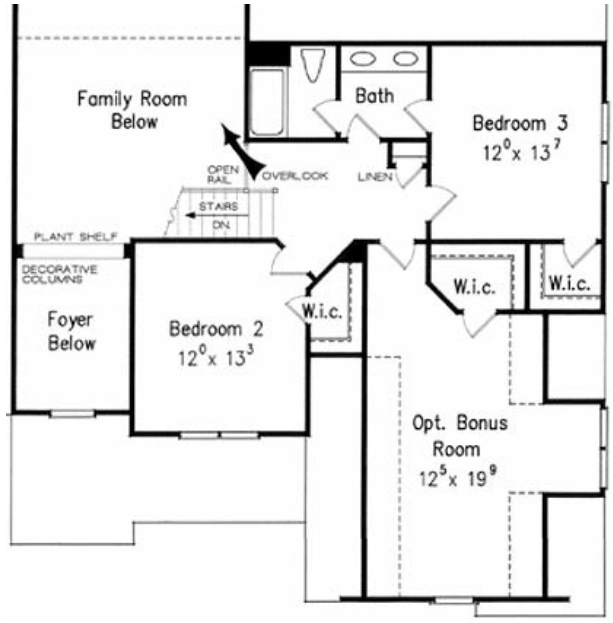

On-Site Sales Office
919-545-2858
www.vollerrealty.com

All prices are subject to lot premiums for location, view, trees and topography.
 Prices and plans subject to change without notice. Information deemed reliable but not guaranteed.

